

Hook MÁLAGA / Percha MÁLAGA

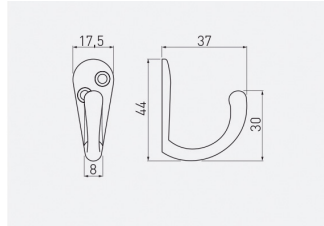

904.951.441	1	ZnAl/ZAMAK	aluminum/aluminio
904.951.622	1	ZnAl/ZAMAK	chrome/cromado
904.951.601	1	ZnAl/ZAMAK	black/negro

Hook RONDO / Percha RONDO

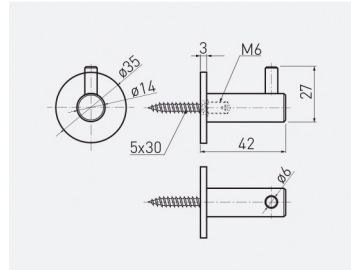

900.410.590	1	steel/acero	brushed steel/acero cepillado
-------------	---	-------------	-------------------------------

Available only for individual order/
Sólo disponible para pedidos individuales.

HOOK K-1 / Percha HOOK K-1

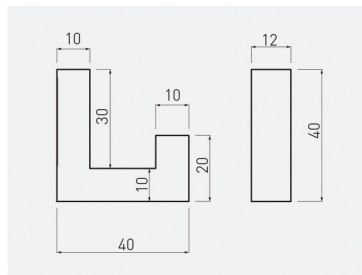

904.201.622	1	ZnAl/ZAMAK	chrome/cromado
904.201.639	1	ZnAl/ZAMAK	brushed steel/acero cepillado
904.201.602	1	ZnAl/ZAMAK	white/blanco
904.201.601	1	ZnAl/ZAMAK	black/negro

HOOK K-2 / Percha HOOK K-2

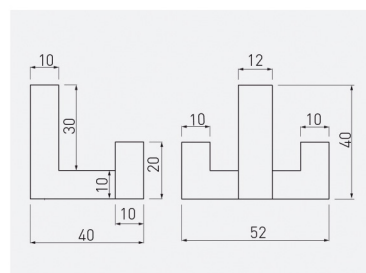

904.202.622	1	ZnAl/ZAMAK	chrome/cromado
904.202.639	1	ZnAl/ZAMAK	brushed steel/acero cepillado
904.202.602	1	ZnAl/ZAMAK	white/blanco
904.202.601	1	ZnAl/ZAMAK	black/negro

Hook MISA / / Percha MISA

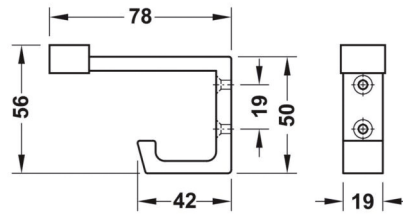

904.842.321

1

aluminum/aluminio

silver/plata

Hook ECI / / Percha ECI



902.860.532

1

ZnAl/ZAMAK

matt chrome/cromo mate



Hook BAR / / Percha BAR

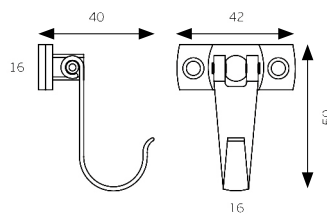

904.548.590

1

steel/acero

stainless steel/INOX

Tubular Hook / / Percha Tubular



904.071.590

10

ø 15 x 93 mm.

steel/acero

stainless steel/INOX

DIENER L hanger / / Colgador DIENER L

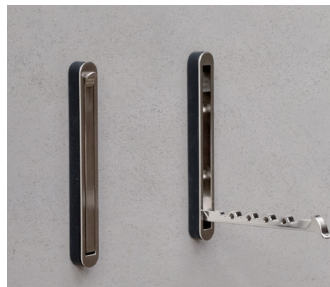
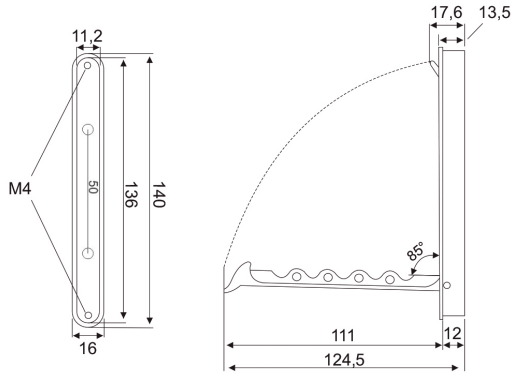

MONTAJE ENCASTRADO



904.736.622	1	ZnAl/ZAMAK	chrome polished/cromo pulido
904.736.624	1	ZnAl/ZAMAK	satin chrome plated/cromado satinado
904.736.639	1	ZnAl/ZAMAK	stainless steel finish/acero inox

Load capacity: / Capacidad de carga: 5 kg.
Dimensions: / Medidas: 136 x 16 x 13,5 mm.

Accessories / Accesorios:

- 2 screws for front fixation: 3,5 x 16 mm. / 2 tornillos para fijación frontal: 3,5 x 16 mm.
- 2 screws for back fixation: M4 x 12 mm. / 2 tornillos para fijación trasera: M4 x 12 mm.

MONTAJE SOBREPUESTO

For screwed on front fixation / Para atornillar en fijación frontal.



Silicon strap /
Correa de silicona



904.700.701	10	silicona	black/negro
-------------	----	----------	-------------

For screwed on front fixation / Para atornillar en fijación frontal.

DIENER S hanger / / Colgador DIENER S

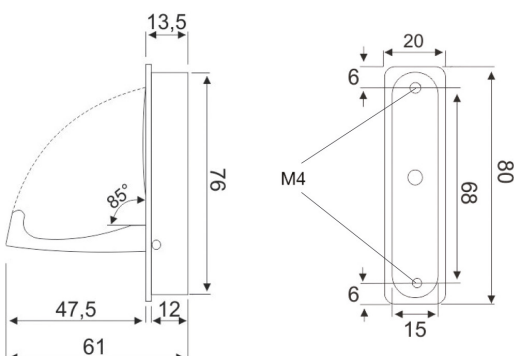

904.036.622	1	ZnAl/ZAMAK	chrome polished/cromo pulido
904.036.624	1	ZnAl/ZAMAK	satin chrome plated/cromado satinado
904.036.639	1	ZnAl/ZAMAK	stainless steel finish/acero inox

Load capacity: / Capacidad de carga: 5 kg.
Dimensions: / Medidas: 76 x 20 x 13,5 mm.

Accessories / Accesorios:

- 1 screw for front fixation: 3,5 x 16 mm. / 1 tornillo para fijación frontal: 3,5 x 16 mm.
- 2 screws for back fixation: M4 x 12 mm. / 2 tornillos para fijación trasera: M4 x 12 mm.

Hook HANGER SE / Percha HANGER SE

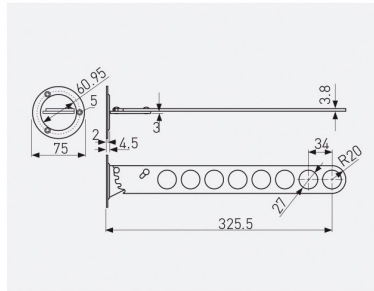

904.029.532	1	universal	steel/acero	chrome/cromado

Removable hanger / Colgador extraible TROMPETA

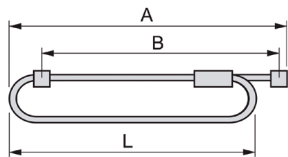

904.340.532	10	A: 335 mm. B: 302 mm. L: 300 mm.	aluminum/aluminio	painted/pintado
904.360.532	10	A: 385 mm. B: 352 mm. L: 350 mm.	aluminum/aluminio	painted/pintado
904.361.532	10	A: 435 mm. B: 402 mm. L: 400 mm.	aluminum/aluminio	painted/pintado
904.362.532	10	A: 485 mm. B: 452 mm. L: 450 mm.	aluminum/aluminio	painted/pintado

Removable hanger / Colgador extraible TROMBÓN

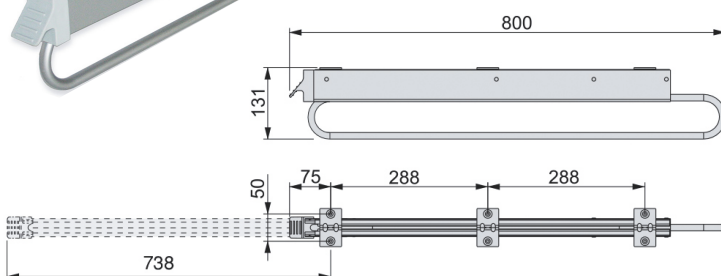
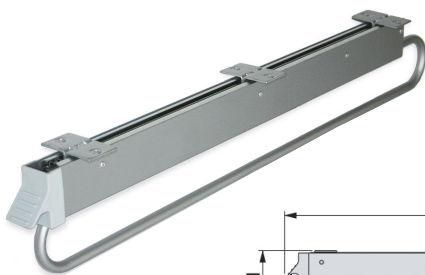

904.340.532	1	universal	steel/acero	chrome/cromado

Folding hanger / Colgador abatible HANG







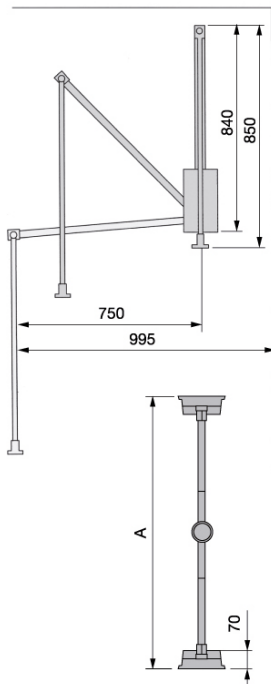

901.245.323	1	L: 450-600 mm.	aluminum/aluminio	moka painted/pintado moka
901.260.323	1	L: 600-830 mm.	aluminum/aluminio	moka painted/pintado moka
901.283.323	1	L: 830-1150 mm.	aluminum/aluminio	moka painted/pintado moka
901.245.321	1	L: 450-600 mm.	aluminum/aluminio	aluminum/aluminio
901.260.321	1	L: 600-830 mm.	aluminum/aluminio	aluminum/aluminio
901.283.321	1	L: 830-1150 mm.	aluminum/aluminio	aluminum/aluminio

Support max 12 kg/ Soporta hasta 14 kg.



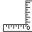



Round wardrobe rail / / Tubo redondo de armario



					
901.212.532	15	L: 2000 mm. Ø 12 mm.	0,8 mm.	steel/acero	chrome/cromado
901.216.532	15	L: 3000 mm. Ø 16 mm.	0,8 mm.	steel/acero	chrome/cromado
901.219.532	15	L: 3000 mm. Ø 19 mm.	1 mm.	steel/acero	chrome/cromado
901.226.532	15	L: 3000 mm. Ø 25 mm.	1 mm.	steel/acero	chrome/cromado





TUBO side bushing support / / Soporte casquillo lateral TUBO

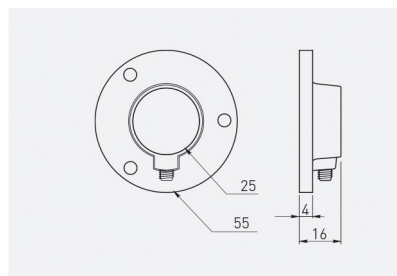

				
902.212.532	250	Ø 12 mm.	iron/hierro	chrome/cromado
902.216.532	100	Ø 16 mm.	iron/hierro	chrome/cromado
902.219.532	100	Ø 19 mm.	iron/hierro	chrome/cromado





R-25 mounting bracket for round rail / / Soporte costado tubo armario R-25



				
902.223.532	50	Ø 25 mm.	steel/acero	chrome/cromado

Center bar support / / Soporte barra central TUBO



				
902.220.532	10	Ø 19 mm.	ZnAl/aluminio de zinc	chrome/cromado
902.227.532	10	Ø 25 mm.	ZnAl/aluminio de zinc	chrome/cromado

∅28 mm tube / Tubo ∅ 28 mm.

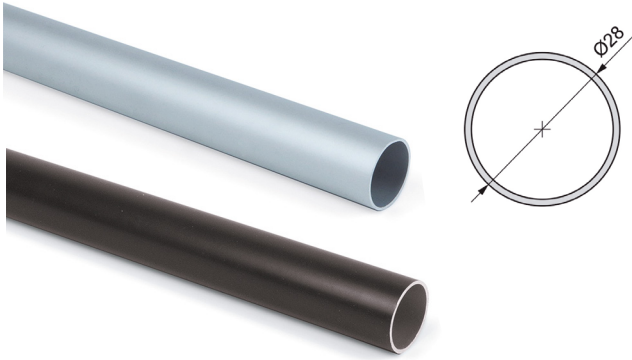

901.228.321	10	L: 2 m.	aluminum/aluminio	matte anodized/anodizado mate	
901.228.323	10	L: 2 m.	aluminum/aluminio	moka	
901.248.321	10	L: 4 m.	aluminum/aluminio	matte anodized/anodizado mate	
901.248.323	10	L: 4 m.	aluminum/aluminio	moka	



Support ∅28 mm tube / Soporte para tubo ∅ 28 mm.

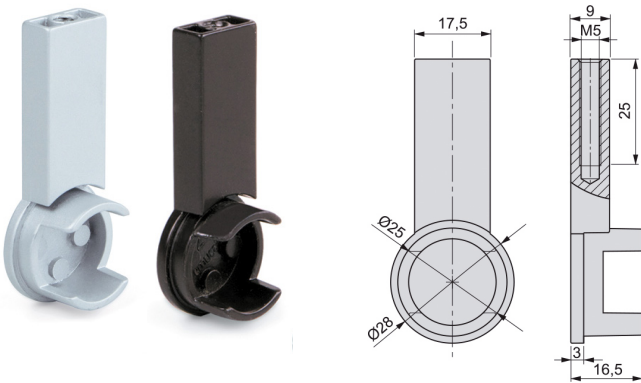

902.228.321	100	aluminum/aluminio	aluminum painted/aluminio pintado	
902.228.323	100	aluminum/aluminio	painted moka/moka pintado	



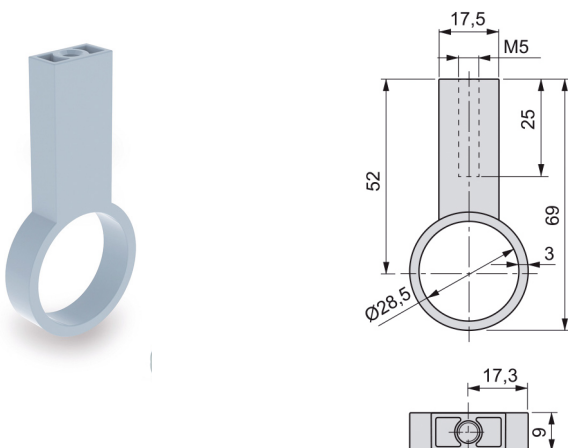

Central support ∅28 mm tube / Soporte central para tubo ∅ 28 mm.

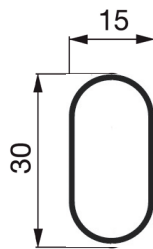

902.220.321	10	aluminum/aluminio	aluminum painted/aluminio pintado	
902.220.323	10	aluminum/aluminio	painted moka/moka pintado	





OVAL-ACE wardrobe rail / Barra armario ACE-OVAL

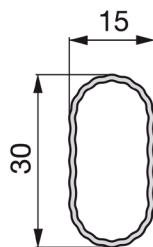

					
901.230.582	10	L: 3000 mm.	steel/acero	chrome/cromado	
901.230.552	10	L: 3000 mm.	steel/acero	brass/latonado	





ALU-OVAL wardrobe rail / Barra armario ALU-OVAL

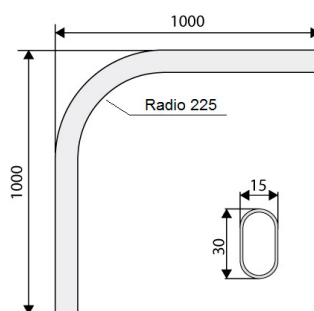

					
901.293.321	10	L: 3,95 m.	aluminum/aluminio	matte silver/plata mate	
	10	L: 2 m.	aluminum/aluminio	matte gold/oro mate	
901.230.322	10	L: 3,95 m.	aluminum/aluminio	matte silver/plata mate	
	10	L: 2 m.	aluminum/aluminio	matte gold/oro mate	

ALU-OVAL corner wardrobe rail / Barra armario ALU-OVAL esquinero



					
901.220.321	10	L: 1 m. x 1 m.	aluminum/aluminio	matte silver/plata mate	
901.220.322	10	L: 1 m. x 1 m.	aluminum/aluminio	matte gold/oro mate	

Fixed ceiling support closed/open / / Soporte fijo techo OVAL



Code	Qty	State	Material	Finish
902.232.607	1	open/abierto	ZnAl/ZAMAK	nickel/niquel
902.232.642	1	open/abierto	ZnAl/ZAMAK	aluminum/aluminio
902.232.552	1	open/abierto	ZnAl/ZAMAK	brass/latonado
902.031.607	1	closed/cerrado	ZnAl/ZAMAK	nickel/niquel
902.032.642	1	closed/cerrado	ZnAl/ZAMAK	aluminum/aluminio
902.232.652	1	closed/cerrado	ZnAl/ZAMAK	brass/latonado

Angle bracket for oval rail / / Soporte central barra OVAL regulable

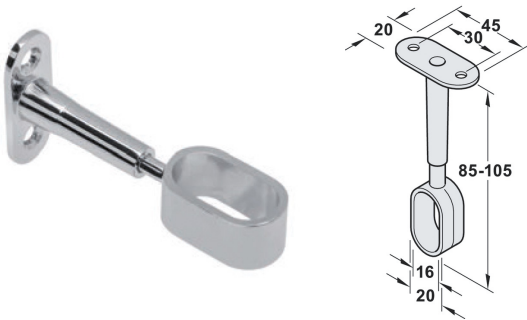

Code	Qty	Material	Finish
902.232.642	20	ZnAl/ZAMAK	chrome/cromado

Bracket oval wardrobe OVAL LUX / / Soporte barra armario OVAL LUX



Code	Qty	Dimensions	State	Material	Finish
902.291.642	25	A: 25 mm. B: 67 mm. C: 13 mm.	closed/cerrado	ZnAl/ZAMAK	matte silver/plata mate
902.292.642	25	A: 25 mm. B: 67 mm. C: 12 mm.	open/abierto	ZnAl/ZAMAK	matte silver/plata mate

Corner support OVAL / / Soporte rinconera OVAL



Code	Qty	Material	Finish
902.293.642	25	ZnAl/ZAMAK	matte silver/plata mate
902.293.622	25	ZnAl/ZAMAK	matte gold/oro mate

Mounting bracket for oval wardrobe / / Soporte lateral barra armario OVAL

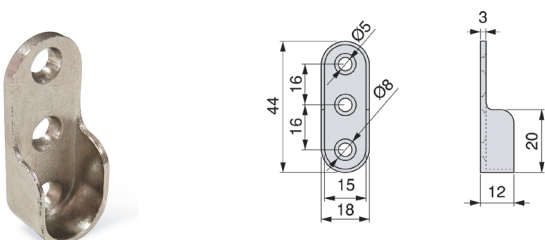

Code	Qty	Material	Finish
902.230.642	100	ZnAl/ZAMAK	nickel/niquel
902.230.621	100	ZnAl/ZAMAK	aluminum/aluminio

VOLKO set hinge for shoe rack two levels / Zapatero abatible 2 niveles VOLKO

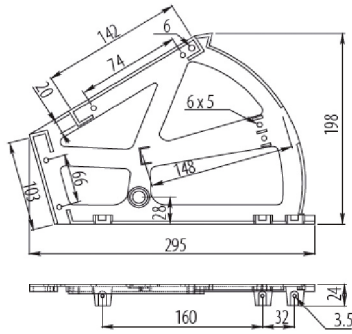

905.744.720	1	plastic/plástico	white/blanco
905.744.701	1	plastic/plástico	black/negro

For 12 mm board /
Para talero de 12 mm.



Extension shoe rack / Soporte zapatero extensible

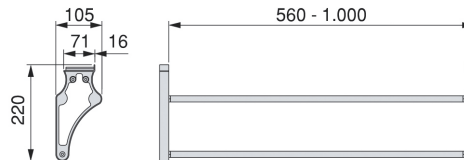
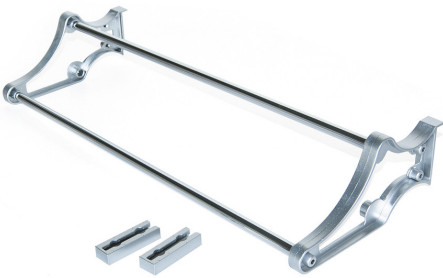

903.905.532	1	L: 560-1000 mm.	steel-plastic/acero-plástico	aluminum painted/pintado aluminio
-------------	---	-----------------	------------------------------	-----------------------------------

Removable front shoe rack with supports / Zapatero extraíble frontal con soportes



903.400.532	1	L: 450-600 mm.	steel/acero	chrome/cromado
903.600.532	1	L: 550-800 mm.	steel/acero	chrome/cromado
903.600.532	1	L: 650-1000 mm.	steel/acero	chrome/cromado



Side removable pants EKOINT / Pantalonero lateral extraíble EKOINT

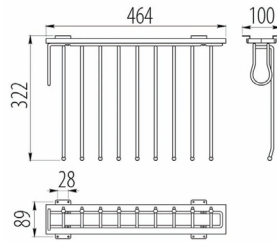

903.090.532	4	fijación DERECHA	steel/acero	chrome/cromado
903.091.532	4	fijación IZQUIERDA	steel/acero	chrome/cromado

- 9 rods / 9 barras
- Partial extraction / Extracción parcial
- Left side installation / Instalación lateral izquierdo



Removable pants EKOINT / Pantalonero extraíble EKOINT

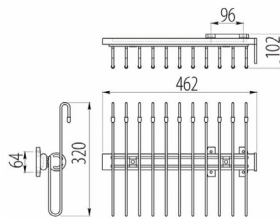
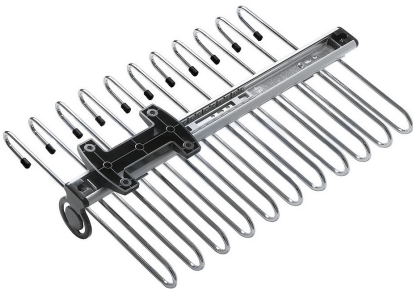

903.311.532	4	steel/acero	chrome/cromado

- 11 rods / 11 barras
- Partial extraction / Extracción parcial
- ??????? installation / Instalación BAJO PAÑO



Double removable pants EKOINT / Pantalonero doble extraíble EKOINT

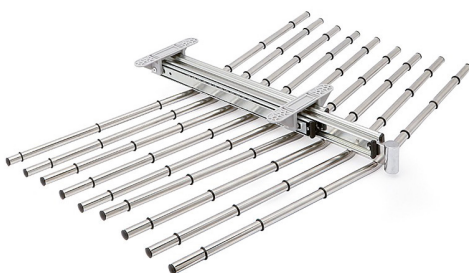

903.018.532	1	steel/acero	chrome/cromado

- 18 rods + handle / 18 barras + tirador
- Total extraction / Extracción total
- Upper part installation / Instalación parte superior

Fleece belt tie / / Corbatero cinturonero batiente

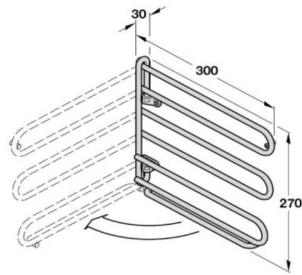

903.280.532

1

steel/acero

chrome/cromado



Belt and tie rack / / Corbatero cinturonero lateral extraíble

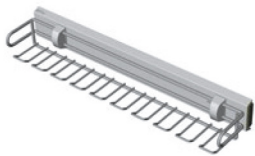

1

steel/acero

chrome/cromado

Removable hanger MIKI / / Colgador oculto extraíble

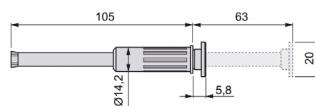

902.001.552

1

aluminum/aluminio





chrome/cromado

Dressing room accessories ELITE / Accesorios para vestidor ELITE



Openwork basket / Cesta calada







			L mm. 		
908.600.502	1	600	metal	blanco/white	
908.600.505	1	600	metal	anthracite/antracita	
908.700.502	1	700	metal	blanco/white	
908.700.505	1	700	metal	anthracite/antracita	
908.800.502	1	800	metal	blanco/white	
908.800.505	1	800	metal	anthracite/antracita	
908.900.502	1	900	metal	blanco/white	
908.900.505	1	900	metal	anthracite/antracita	

- Width adjustment up to 60 mm / Ajuste de anchura hasta 60 mm.
- Minimal cabinet depth 500 mm / Profundidad mínima del hueco 500 mm.



Accesorios organiser / / Bandeja de accesorios





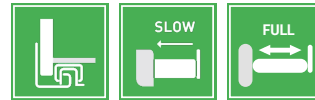

			L mm		
918.600.502	1		600	metal	blanco/white
918.600.505	1		600	metal	anthracite/antracita
918.700.502	1		700	metal	blanco/white
918.700.505	1		700	metal	anthracite/antracita
918.800.502	1		800	metal	blanco/white
918.800.505	1		800	metal	anthracite/antracita
918.900.502	1		900	metal	blanco/white
918.900.505	1		900	metal	anthracite/antracita

- Width adjustment up to 60 mm /
Ajuste de anchura hasta 60 mm.
- Minimal cabinet depth 500 mm /
Profundidad mínima del hueco 500 mm.



Wardrobe trouser rack / / Pantalонера





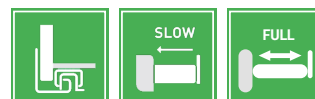

			L mm		
928.600.502	1		600	metal	blanco/white
928.600.505	1		600	metal	anthracite/antracita
928.700.502	1		700	metal	blanco/white
928.700.505	1		700	metal	anthracite/antracita
928.800.502	1		800	metal	blanco/white
928.800.505	1		800	metal	anthracite/antracita
928.900.502	1		900	metal	blanco/white
928.900.505	1		900	metal	anthracite/antracita

- Width adjustment up to 60 mm /
Ajuste de anchura hasta 60 mm.
- Minimal cabinet depth 500 mm /
Profundidad mínima del hueco 500 mm.



Shoe cabinet / Zapatero





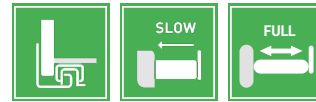

					
938.600.502	1	600	metal	blanco/white	
938.600.505	1	600	metal	anthracite/antracita	
938.700.502	1	700	metal	blanco/white	
938.700.505	1	700	metal	anthracite/antracita	
938.800.502	1	800	metal	blanco/white	
938.800.505	1	800	metal	anthracite/antracita	
938.900.502	1	900	metal	blanco/white	
938.900.505	1	900	metal	anthracite/antracita	

- Width adjustment up to 60 mm /
Ajuste de anchura hasta 60 mm.
- Minimal cabinet depth 500 mm /
Profundidad mínima del hueco 500 mm.



Rattan basket case / Cesto de rattan



					
948.600.502	1	600	metal	blanco/white	
948.600.505	1	600	metal	anthracite/antracita	
948.700.502	1	700	metal	blanco/white	
948.700.505	1	700	metal	anthracite/antracita	
948.800.502	1	800	metal	blanco/white	
948.800.505	1	800	metal	anthracite/antracita	
948.900.502	1	900	metal	blanco/white	
948.900.505	1	900	metal	anthracite/antracita	

- Width adjustment up to 60 mm /
Ajuste de anchura hasta 60 mm.
- Minimal cabinet depth 500 mm /
Profundidad mínima del hueco 500 mm.

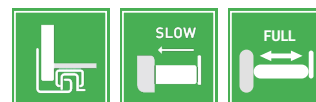

Removable mirror / / Espejo extraíble

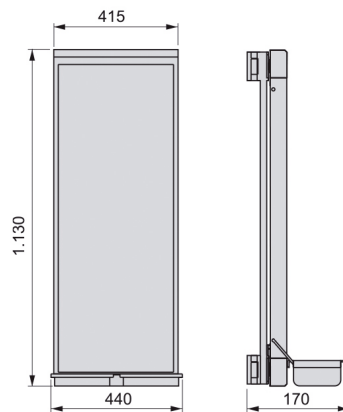

903.198.532

1

aluminum/aluminio

moka painted/pintado moka

Removable mirror / / Espejo extraíble



Mirror for removable guides / / Espejo para guía extraíble



903.762.507

1

900 x 400 mm.

aluminum/aluminio

matte anodized/anodizado mate

Guides for removable mirror / / Bastidor



903.625.507

1

aluminum/aluminio

painted/pintado

Support max 8 kg / Soporta hasta 18 kg.

